

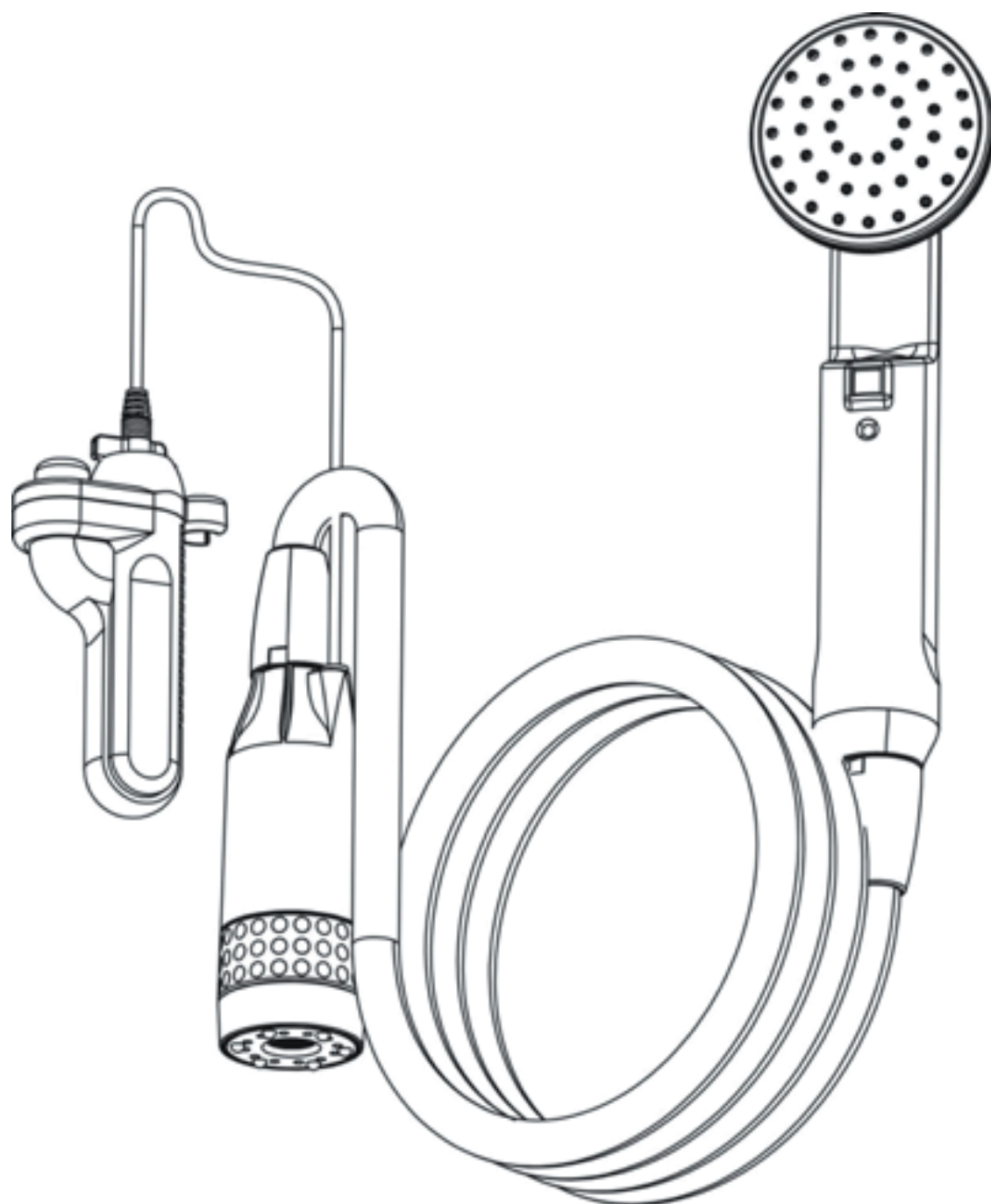

RECHARGEABLE WATERPUMP

GFS-1705S

Operating Instructions



IMPORTANT SAFETY INSTRUCTIONS

1. Please read all instructions before using the appliance.
2. Know how to stop the product and bleed pressures quickly.
3. Follow the maintenance instructions specified in the manual.
4. Operate only with water within the temperature range 10°C to 50°C.
5. Shower assembly includes small parts that could be a choking hazard.

WARNING

TO REDUCE THE RISK OF INJURY:

1. Do not leave appliance unattended when in use. Switch the unit off and remove from water when not in use.
2. Use only as described in this manual with manufacturers recommended attachments and replacement parts.
3. Do not use the shower with water from the sea, pool or river or with any liquid other than water.
4. Ensure that the base of the pump is fully submerged in water before operation.
5. When the shower is operated by children, proper instruction and attention should be given.
6. Do not use damaged power cord or plug and charge only with correct voltage as listed on the shower plate. Using improper voltage may result in damage to the motor and possible injury to the user.
7. Before use, ensure that there are no broken or worn parts and that all screws are fully tightened.
8. Keep the shower away from heating or fire.
9. Keep the shower away from freezing. Freezing will damage the motor and cord.
10. Do not remove cover plate or attempt to disassemble your machine. This will void all warranties.

FEATURES

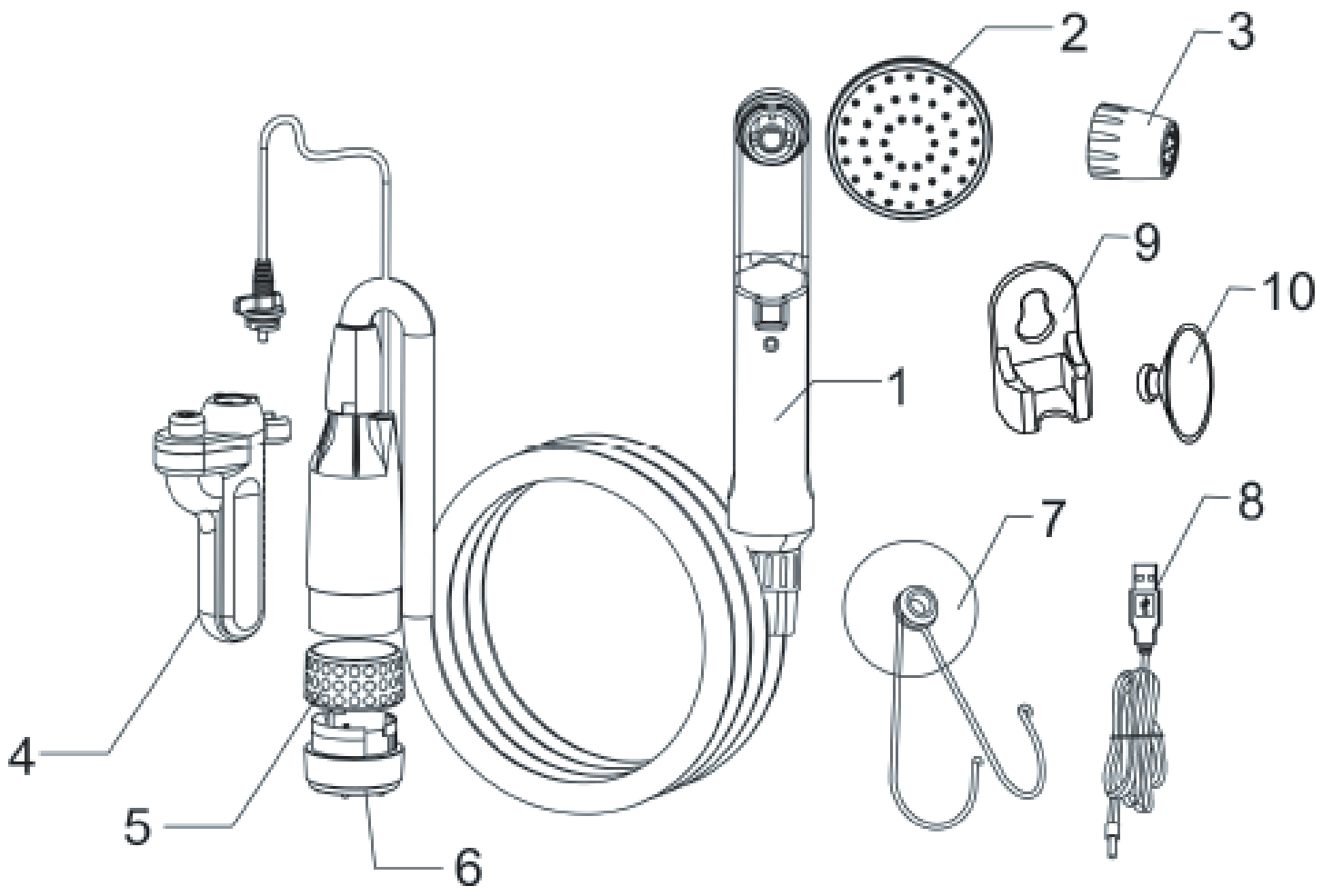

- 1. Handle
- 2. Shower head
- 3. Mini bidet head
- 4. Battery pack
- 5. Protective cover
- 6. Filter cover
- 7. Hook holder
- 8. USB cable
- 9. Holder
- 10. Suction cup

HOW TO OPERATE

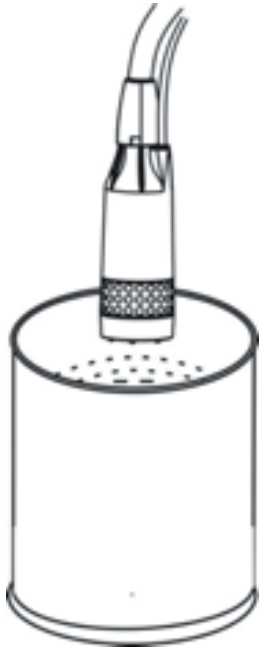

Lower pump into water.

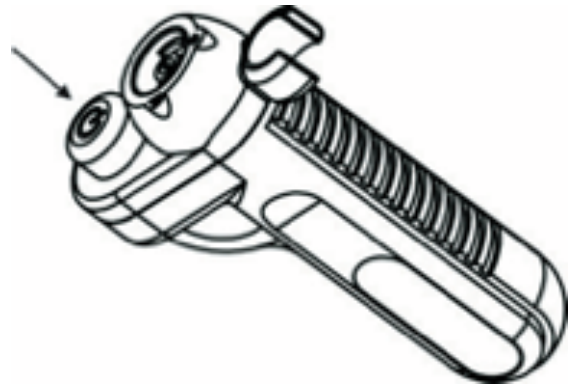

Press on/off on battery pack to start.

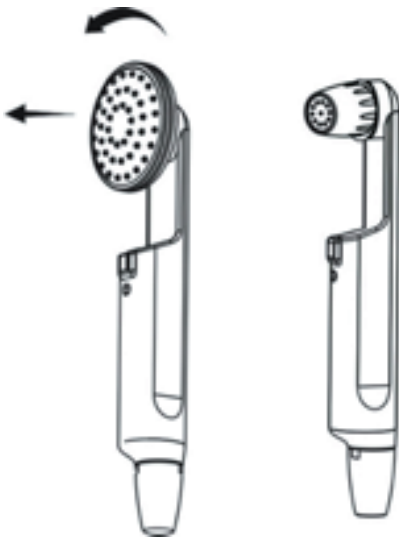

Replace the shower head.

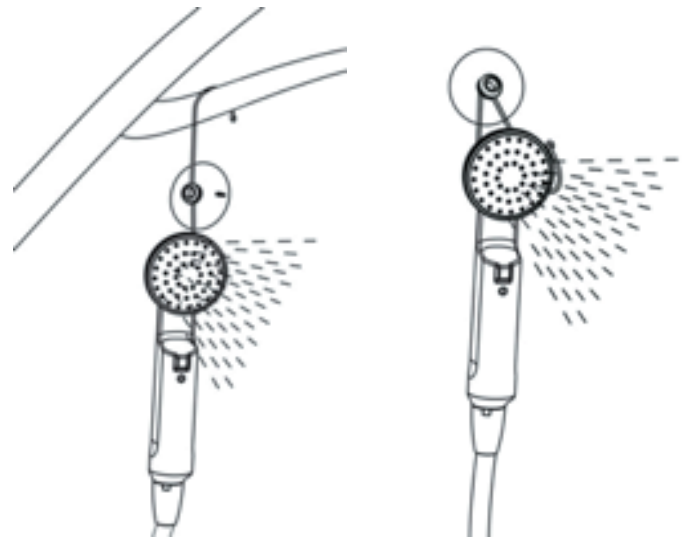

Position shower head using supplied hook.

IMPORTANT:

1. Do not remove the pump from water when operating. Power off the battery before removing the pump.
2. Ensure the shower head is securely mounted before use.
3. Do not lower the battery pack into water.

HOW TO RECHARGE

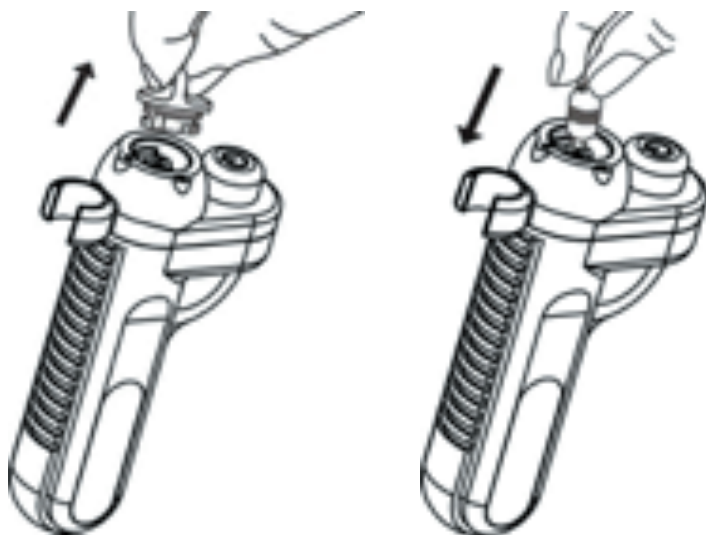

Open the socket cover of USB, the indicator light is red when charging; the indicator light turns Blue when charging is completed.



Plug USB charging cord into:

- **Mobile phone charger (2.5h)**
- **USB output from car (2.5h)**
- **USB output from laptop (5h)**

(approximate charging times)

Do not charge with power source over 5V.

GENERAL MAINTENANCE

FOR SHOWER DEVICE

1. Unattach the shower device



Stop the device by pressing the on/off switch on battery supply.

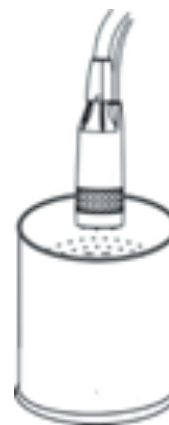

Remove the pump from the water and drain water from the hose.

IMPORTANT: Please store the pump away from high temperature, freezing, flammable and explosive items.

1. Cleaning the filter

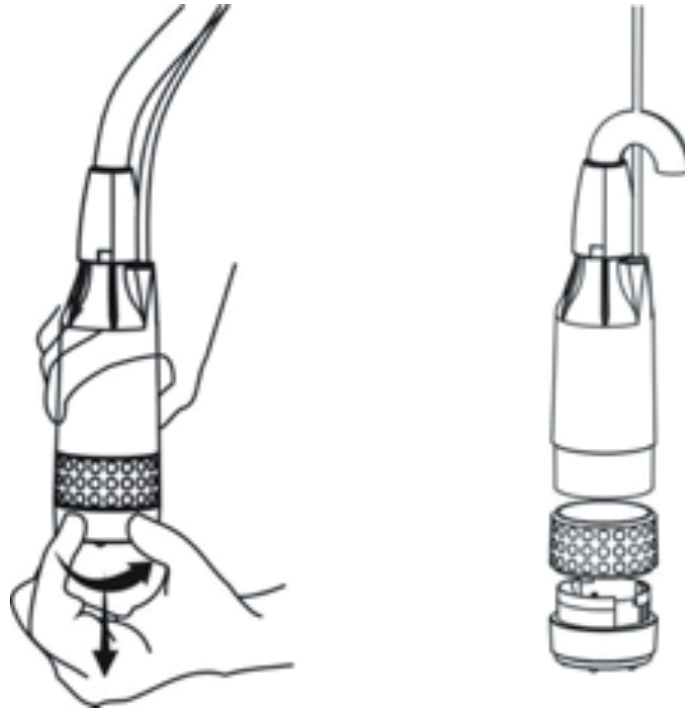

Remove the filter cover and clean the filter (5) and filter cover (6).

FOR BATTERY SUPPLY

1. We recommend charging the battery to SOC 40%-50% after each use to ensure the maximum battery life.
Please charge before using for the first time.
2. Please recharge the battery at least every three months to ensure it remains in a SOC 40%-50% – the battery will deplete when stored for long periods.
3. Do not charge the battery beyond output specification the products required (Output: 5V / 0.5-2A.).
4. Store away from high temperatures or flammable & explosive goods.

SPECIFICATIONS

Voltage	3.7 V
Max. electric flow	2.5 A
Water flow	2.5 L/min
Battery capacity	2200 mAH
Using time	45-60 min

Hose	1.8 m
Power supply	Rechargeable Lithium Battery Supply included
Charging method	Any USB output of 5V, 0.5 - 2A
Charging time	2 - 5 hours (depending on specifications of the charger)